

POWERHOUSE™ HTD® TIMING PULLEYS

3 mm Pitch
For 6 mm Wide Belts
Hub
Aluminum
Clear Anodized
Finished Bore

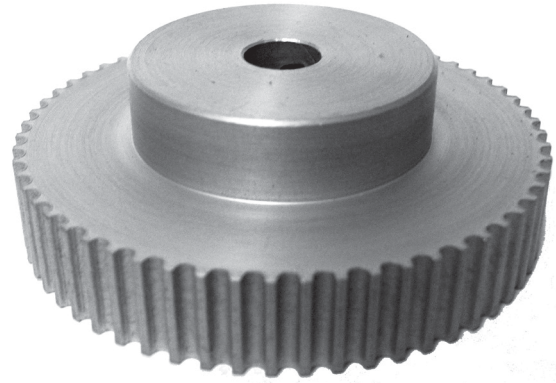

Part Number	No. of Teeth	Type	Pitch Dia (in)	Out. Dia (in)	Bore (in)	Face Width (in)	Overall Length (in)	Hub Dia. (in)	Set Screw
18-3M06-6A3	18	6	0.677	0.647	0.250	0.386	0.691	0.442	2 x 8-32 @ 90°
19-3M06-6A3	19	6	0.714	0.684	0.250	0.386	0.691	0.468	2 x 8-32 @ 90°
20-3M06-6A3	20	6	0.752	0.722	0.250	0.386	0.691	0.500	2 x 8-32 @ 90°
22-3M06-6A3	22	6	0.827	0.797	0.250	0.386	0.691	0.562	2 x 8-32 @ 90°
24-3M06-6A3	24	6	0.902	0.872	0.250	0.386	0.691	0.625	2 x 8-32 @ 90°
25-3M06-6A3	25	6	0.940	0.910	0.250	0.386	0.691	0.625	2 x 8-32 @ 90°
26-3M06-6A3	26	6	0.977	0.947	0.250	0.386	0.691	0.625	2 x 8-32 @ 90°
28-3M06-6A3	28	6	1.053	1.023	0.250	0.386	0.691	0.701	2 x 8-32 @ 90°
30-3M06-6A3	30	6	1.128	1.098	0.250	0.386	0.691	0.776	2 x 8-32 @ 90°
32-3M06-6A3	32	6	1.203	1.173	0.250	0.386	0.691	0.851	2 x 8-32 @ 90°
34-3M06-6A3	34	6	1.278	1.248	0.250	0.407	0.713	0.921	2 x 8-32 @ 90°
36-3M06-6A3	36	6	1.353	1.323	0.250	0.407	0.713	1.000	2 x 8-32 @ 90°
38-3M06-6A3	38	6	1.429	1.399	0.250	0.407	0.713	1.075	2 x 8-32 @ 90°
40-3M06-6A3	40	6	1.504	1.474	0.250	0.407	0.713	1.150	2 x 8-32 @ 90°
44-3M06-6A3	44	6	1.654	1.624	0.250	0.407	0.713	1.300	2 x 8-32 @ 90°
48-3M06-6A4	48	6	1.805	1.775	0.313	0.407	0.734	1.250	2 x 8-32 @ 90°
50-3M06-6A4	50	6	1.880	1.850	0.313	0.407	0.734	1.250	2 x 8-32 @ 90°
56-3M06-6A4	56	6	2.105	2.075	0.313	0.407	0.734	1.250	2 x 8-32 @ 90°
60-3M06-6A4	60	6	2.256	2.226	0.313	0.407	0.734	1.250	2 x 8-32 @ 90°
62-3M06-6A4	62	6	2.331	2.301	0.313	0.407	0.734	1.250	2 x 8-32 @ 90°
72-3M06-6A4	72	6	2.707	2.677	0.313	0.407	0.734	1.250	2 x 8-32 @ 90°

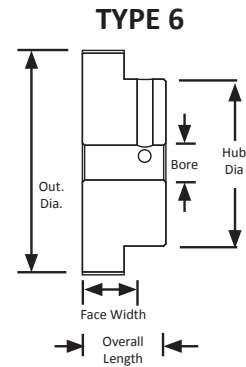

POWERHOUSE™ HTD® pulleys have the FIRST® generation of curvilinear tooth profiles. They are designed to be fully compatible with the older HTD® standard tooth profiles which includes B&B Manufacturing's POWERHOUSE™ HTD® belts. These drives are also designed to handle a wide range of belt speeds and generate virtually no friction.

The steel and iron versions of these industry standards have larger load capacities than their aluminum or plastic counterparts due to the higher strength and firmness of steel and iron. POWERHOUSE™ HTD® pulleys are offered in 3 mm, 5 mm, and 8 mm pitches from stock and 14 mm pitch on from the B&B Manufacturing Custom Shop. POWERHOUSE™ HTD® pulleys are offered with inch minimum plain bores, metric minimum plain bores, QD® bushings, or Taper-Lock bushings. They are also offered in aluminum, steel, or iron.